

Roof Plan

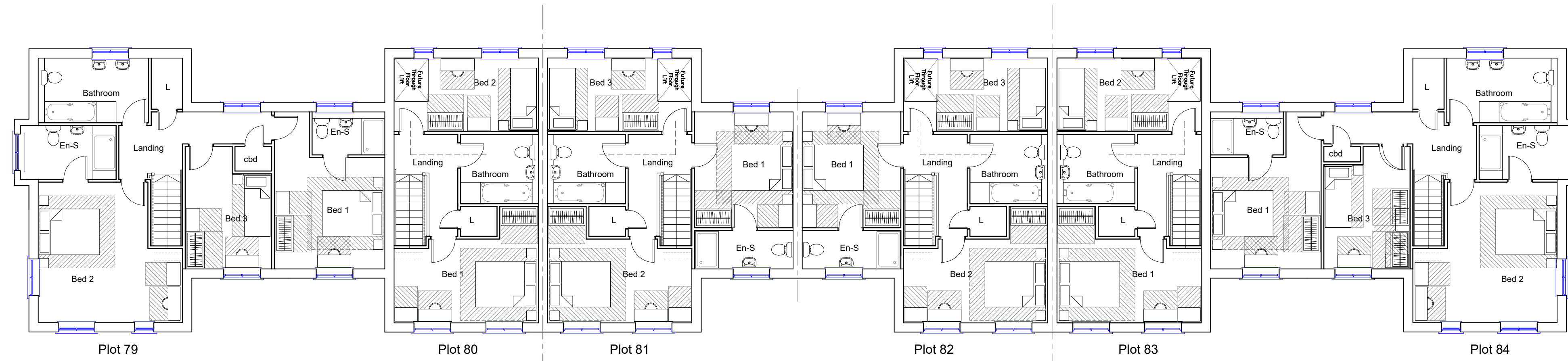

First Floor Plan

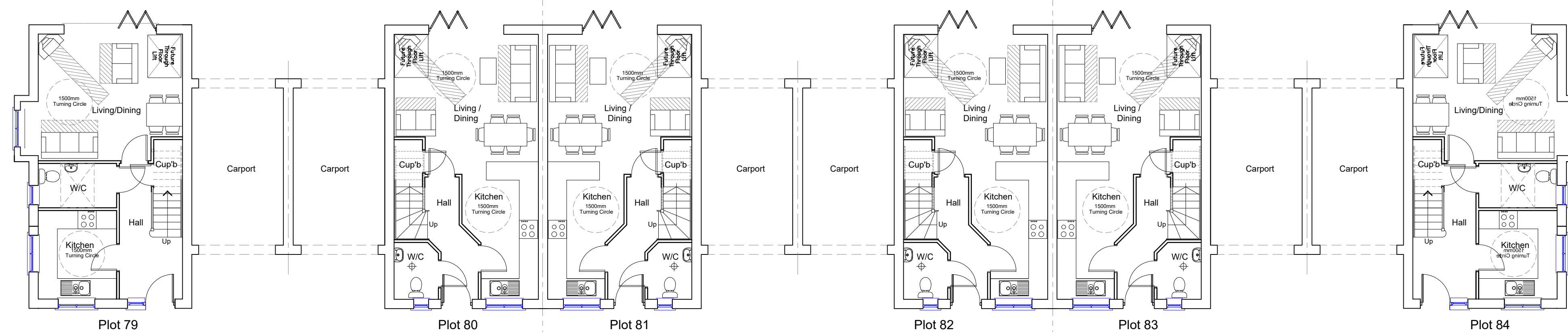

Ground Floor Plan

		Scale Bar
		Scale : 1:100 @ A1
		Date : Nov2018
		Status : PLANNING
		Dwg No : 2018.191.029
		Rev :
Patrick Stroud Designs Ltd 10 Hurstwood Avenue, Brentwood, Essex CM15 9HT T: 01277 260130 / 07955 687623 E: patrick@stroudesigns.com		
Client : Marden Homes Ltd		
Project : Land at Kelvedon Road, Tiptree		
Drawing : Plots 79-84 Plans		
<small>© THIS DRAWING IS THE COPYRIGHT OF PATRICK STROUD DESIGNS LTD. It shall not be in any way used or reproduced without their prior written consent. All dimensions are to be checked on site or in the workshop prior to commencing any work. Work only to figured dimensions. Any discrepancies are to be reported to the Architect.</small>		